

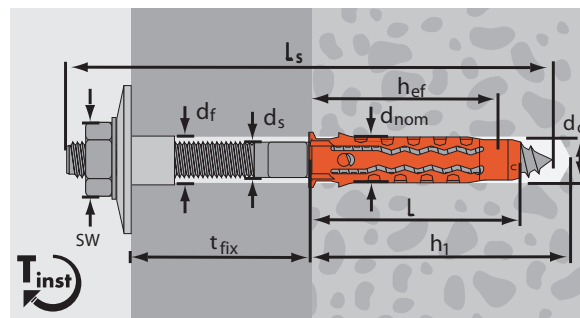

MWTE Sanitary Fixing for Wash Basins

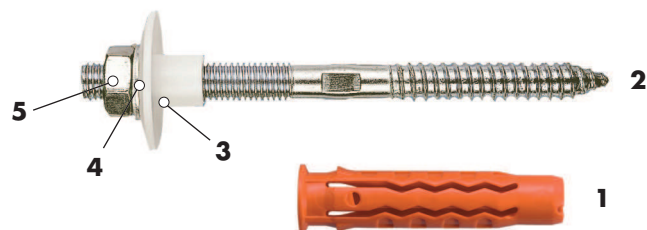

Name

- | | | | |
|---|---------------------|---|-------------|
| 1 | Quattro® Nylon Plug | 4 | Washer |
| 2 | Stick Screw | 5 | Hexagon nut |
| 3 | Flush collar | | |

Features

Face fixing

Building materials



Qualities



Applications



- ① Fixings of wash basins
- ② Fixings of urinals

Installation

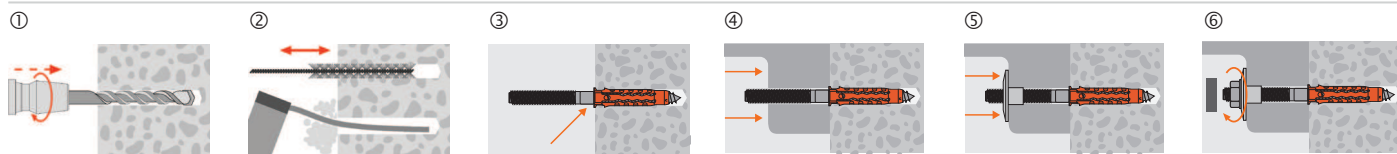

- ① Make the drill hole
- ② Clean the drill hole
- ③ Insert the Nylon Plug, screw in the stick screw until the mark is reached
- ④ Position the building materials
- ⑤ Push on the flush collar and washer
- ⑥ Tighten the nut



Sanitary Fixing for Wash Basins-Installation Kit

Set contents:

Pieces

Article code

MWTE M6 x 70



- MQ Quattro® Nylon Plug 8 x 40	2
- Stick screw SS 6 x 70	2
- Flush collar M6	2
- Nut M6	2
- Washer M6	2

1420201

Sanitary Fixing for Wash Basins-Installation Kit

Set contents:

Pieces

Article code

MWTE M10 x 100



- MQ Quattro® Nylon Plug 14 x 70	2
- Stick screw SS 10 x 100	2
- Flush collar M10	2
- Nut M10	2
- Washer big M10 DIN 9021	2

1420101

Sanitary Fixing for Wash Basins-Installation Kit

Set contents:

Pieces

Article code

MWTE M10 x 120



- MQ Quattro® Nylon Plug 14 x 70	2
- Stick screw SS 10 x 120	2
- Flush collar M10	2
- Nut M10	2
- Washer big M10 DIN 9021	2

1420102

Sanitary Fixing for Wash Basins-Installation Kit

Set contents:

Pieces

Article code

MWTE M10 x 140



- MQ Quattro® Nylon Plug 14 x 70	2
- Stick screw SS 10 x 140	2
- Flush collar M10	2
- Nut M10	2
- Washer big M10 DIN 9021	2

1420103

Technical data and loads MWTE: see Quattro® Nylon Plug on page 1.10