

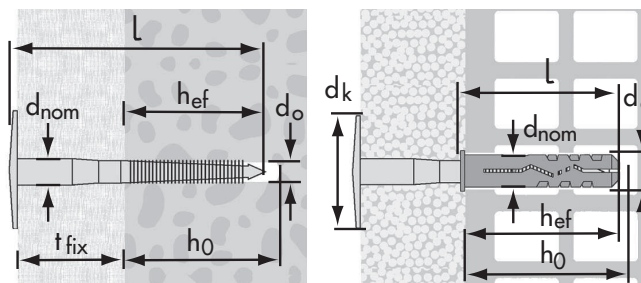

## MIP for Mineral Wool Type

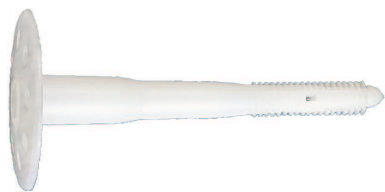

### Name

MIP for Mineral Wool Type      Polyethylene HD

### Building materials



### Qualities



### Characteristics

- Best adhesive power of the plaster
- Suitable for insulating boards up to a weight of 70 kg/m<sup>3</sup>
- No reduction of insulation level
- Reduced assembling time, without screws and nails

### Applications

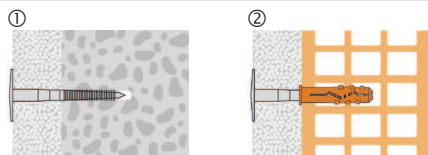

- ① Assemblings in solid materials without plug
- ② Assembling in perforated brick with plug MID  
4 to 7 pieces / m<sup>2</sup> recommended

### Installation

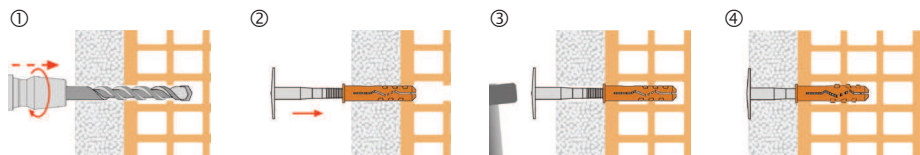

- ① Make the drill hole
  - ② Insert the MIP
  - ③ Drive-in the MIP with a hammer
  - ④ MIP has to be hammered in precisely to the insulation
- 👉 Use insulation plug MID for assemblings of MIP in perforated brick



## MIP

	Plug size		8				
N <sub>Rec</sub> <sup>1)</sup>	- Concrete C20/25 - C50/60, solid brick		0.15				
	- Lightweight concrete	kN	0.12				
	- Perforated brick		0.13				
h <sub>ef</sub>	Effective anchorage depth	Concrete	30				
		Perforated brick	40				
h <sub>0</sub>	Drill hole depth	Concrete	40				
		Perforated brick	50				
d <sub>0</sub>	Drill hole-Ø	mm	8				
d <sub>k</sub>	Plug plate-Ø	mm	45				
l	Plug length	mm	70	90	105	125	155
d <sub>nom</sub>	Plug-Ø	mm	8				
t <sub>fix</sub>	Assembling usable length	Concrete	40	60	75	95	125
		Perforated brick	30	50	65	85	115
			1180001	1180002	1180003	1180004	1180005
Industrial package							
			1180101	1180102	1180103	1180104	1180105

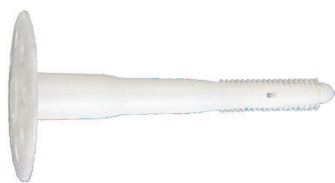

### MIP Insulation fixing

1) Safety factor 3

### Insulation plug for MIP

For application in perforated brick.

## MID

	Plug size		12
h <sub>ef</sub>	Effective anchorage depth	mm	60
h <sub>0</sub>	Drill hole depth	mm	70
d <sub>0</sub>	Drill hole-Ø	mm	12
d <sub>k</sub>	Collar-Ø	mm	15
d <sub>nom</sub>	Plug-Ø	mm	12
l	Plug length	mm	60
			1041260



### MID Insulation plug