

MIDS-K Metal Insulation Nail with head protection cap

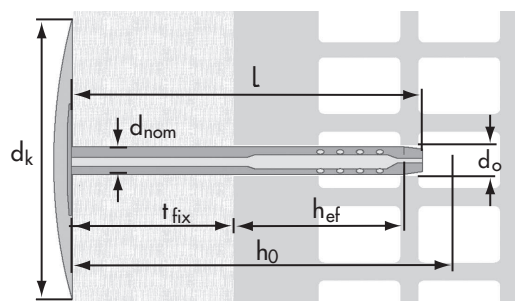
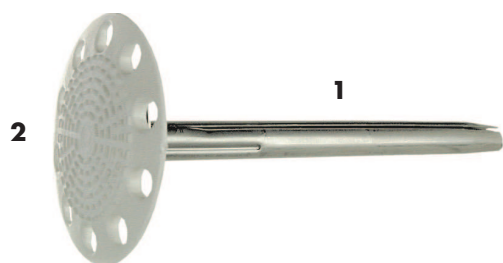

Name

1	Nail	Steel with alu-zinc-surface
2	Cap	Polyamide

Building materials



Qualities



Characteristics

- Applications of soft and pressure resistant insulating material for example mineral wool, glass wool, wood-wool building slab
- Cap reduces cooling / warming transmission
- Fire proof

Applications

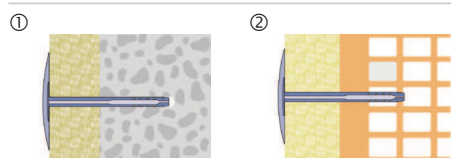

① - ② Applications on most building materials

Installation

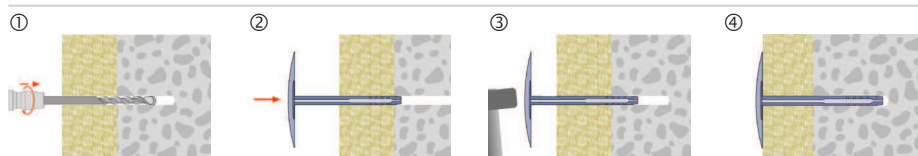

- ① Take drill hole-Ø and drill hole depth from the table (in gas concrete MIDS-K can be driven in without pre-drill)
- ② Insert the MIDS-K
- ③ Drive-in MIDS-K with a hammer
- ④ Insert the disc until the head is flush to the insulation

MIDS-K

		Plug- \varnothing		8				
$N_{Emp}^{1)}$	- Concrete C20/25 - C50/60		kN	0.3				
	- Brick			0.1				
	- Aerated concrete							
	- Perforated brick							
h_{ef}	Effective anchorage depth	Concrete	mm	30				
		Perforated brick	mm	40				
h_0	Setting depth	Concrete	mm	40				
		Perforated brick	mm	50				
d_0	Drill hole- \varnothing in the building materials		mm	8				
d_k	Plug plate- \varnothing		mm	54				
l	Plug length		mm	80	110	140	170	200
d_{nom}	Outside- \varnothing plug		mm	8				
t_{fix}	Assembling usable length concrete		mm	50	80	110	140	170
	Assembling usable length perforated brick			40	70	100	130	160
				1180521	1180522	1180523	1180524	1180525



MIDS-K Metal Insulation Nail with head protection cap

1) Safety factor 3

On request the Insulation Nails MIDS-K are also available in stainless steel A2