

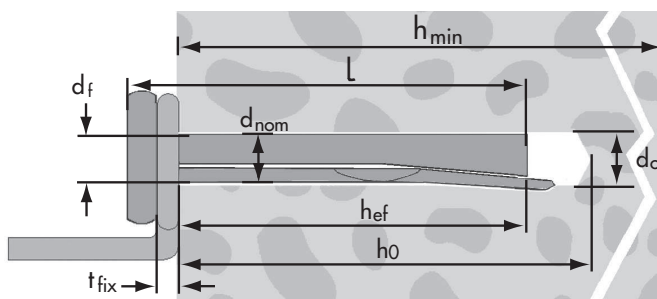

MAN Ceiling Anchor

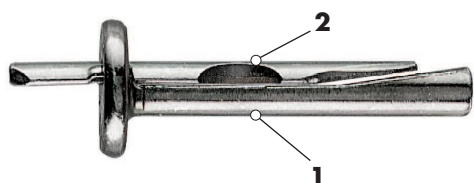

Name

- | | | |
|---|-------------------|----------------------------|
| 1 | Anchor shank | Zinc plated steel |
| 2 | Expansion element | Zinc plated steel annealed |

Features

- Through fixing
- European Technical Approval Part 6
- Approved fire resistance classification F30-F120

Building materials

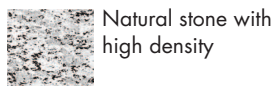
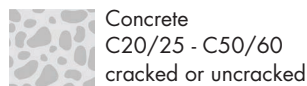

Characteristics

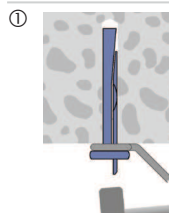

- ① Easy assembly by driving in the expansion element with a hammer
- European Technical Approval Part 6 for anchor made of galvanised steel for multiple use for non - structural applications in concrete

Applications

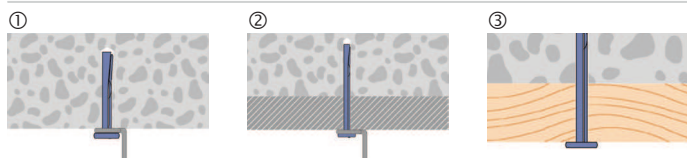

- ① Fastening of punched straps and slot straps for inclinations
- ② Long MAN for bridging of non-bearing layers
- ③ Fixing of wooden slats up to 35 mm thickness

Installation

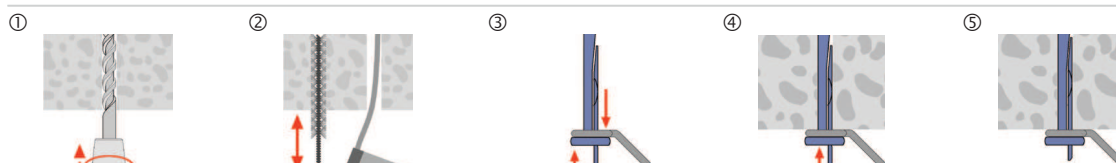

- ① Make the drill hole
- ② Clean the drill hole
- ③ Place the building materials on the Ceiling Anchor
- ④ Place the Ceiling Anchor with building materials concisely into the hole
- ⑤ Drive in the nail with a hammer



MAN

	Anchor-Ø	mm	6	
N_{App}	Concrete uncracked or cracked C20/25 - C50/60	kN	1.2	
V_{App}	Approved shear loads	kN	1.2	
M_{App}	Approved bending moment	Nm	3	
c_{min}	Min. distance to edge	mm	150	
s_{min}	Min. distance betw. anchors	mm	200	
h_{min}	Min. thickness base material	mm	80	
h_{ef}	Effective anchorage depth	mm	32	
h_1	Drill hole depth	mm	50	
d_0	Drill hole-Ø in the building material	mm	6	
d_{cut}	Max. drill hole-Ø	mm	6.4	
d_f	Clearance hole in fixture	mm	6.5	
l	Anchor length	mm	40	70
d_{nom}	Outside-Ø plug	mm	6	
t_{fix}	Assembling usable length	mm	4.5	35



1127064

1127067

MAN Ceiling Anchor

Without the influence of edge- and space distances / According to the approval the partial safety factors as well as a partial safety factor of the effect of $\gamma_F=1.4$ are considered.